



ulla arctic



MV Ulla Rinman

your basecamp at sea for
scientific research, film logistics
and touristic expeditions
in arctic waters



ulla arctic

your basecamp at sea



your floating basecamp in arctic waters

VESSEL HISTORY AND CHARACTERISTICS

Ulla Rinman was built in 1970 as rescue vessel for the Swedish Rescue Society and had been in service for 35 years. It was built with an ice class for rescue missions in the frozen Baltic Sea during winter time. In 2005 Ulla Rinman was sold to a private owner, who refitted the vessel completely. Since 2009 the vessel is registered in Longyearbyen (Svalbard) and has been used as charter vessel for research and touristic expeditions, as well as logistic vessel for photo & film productions. In 2019 Ulla Rinman (Ulla Arctic AS) has been taken over by the Norlengs GmbH, Germany.

The ship has a strengthened bow, an ice propeller and a strong hydraulic bow thruster which provides a save navigation through pack ice. In addition, the pitch propeller gives a great benefit while towing equipment.

CHARTER AND CREWING

The ship is chartered on a daily basis (timecharter). The charterfee includes one captain, one engineer and one deckhand (optional).

Depending on the type and length of the mission, it will be necessary to have extra crew. To sail beyond 12h /day, a second navigator is required. Food and beverages are not included.

Preparing the food and/or hiring a chef is the charterer's responsibility.

Please do not hesitate to contact us being in need for special equipment, polar bear protection guides or a chef. We dispose over an excellent network of logistic providers and guides/chefs on the island.



ulla arctic

your basecamp at sea

Name of the Vessel	Ulla Rinman
Home port	Longyearbyen, Svalbard
Callsign	LKTQ
Register	Norway, NOR
Shipstype	Vessel with limited passenger transport up to 12 PAX
Hull characteristic	Material steel, icebreaking bow, ice strengthened
Engine	Jönköping 6 Zyl 250MD, 530KW/425U/min
Service speed	7,5kn (1,4m ³ /24h)
Maximum speed	12,0kn (3,0m ³ /24h)
Fuel capacity	24m ³
Range	3000nm
Maximum time at sea	60 days/1600nm (needs extra crew)
Length	23,82m
Breadth	6,90m
Draft	3,2m
Brutto tonnage	93GT
Fresh water capacity	3m ³
Watermaker (osmose)	200ltr/h, 2800ltr/24h
2x Generator (auxiliary engine)	380/230V/50Hz 20 KVA
Hydraulic crane/winch	SWL 0,5t/7m foredeck
Hydraulic crane/winch	SWL 0,7t/4m aftdeck
Cabins	6 (4 double cabins, 1 four bed cabin, 1 three bed cabin)
Total banks	15 incl. crew (max pax 12, recommended 8-10)
Shower/WC	1x shower, 2x WC
Communication during fieldwork	2 handheld VHF with GPS, AIS receiver and distress button
Navigation equipment	2 radars, satellite compass, autopilot, echosounder, navtex, AIS, 2xGPS, 2 independent chartplotters, 2 handheld VHF, 2 searchlights Access point for navigation data to share with clients.
Communication	Iridium Satellittelefon, 2 VHF radio DSC



ulla arctic

your basecamp at sea

Dinghy 1 Zodiac Milpro MK 5 HD

Capacity Number of persons (ISO6185): 15 POB
Maximum payload (ISO6185): 2520 kg
Floorboard usable area: 4,61 m²
Buoyancy tube volume: 3,70 m³

Dimensions Overall length: 5,85 m
Inside length: 4,20 m
Overall width: 2,48 m
Inside width: 1,22 m
Buoyancy tube diameter: 0,63 m

Engine Yamaha 50 hp



Dinghy 2 Pioner 14ft

Material Polyethylen RIP
Dimensions Overall length: 4,20 m
Engine Suzuki 30 hp

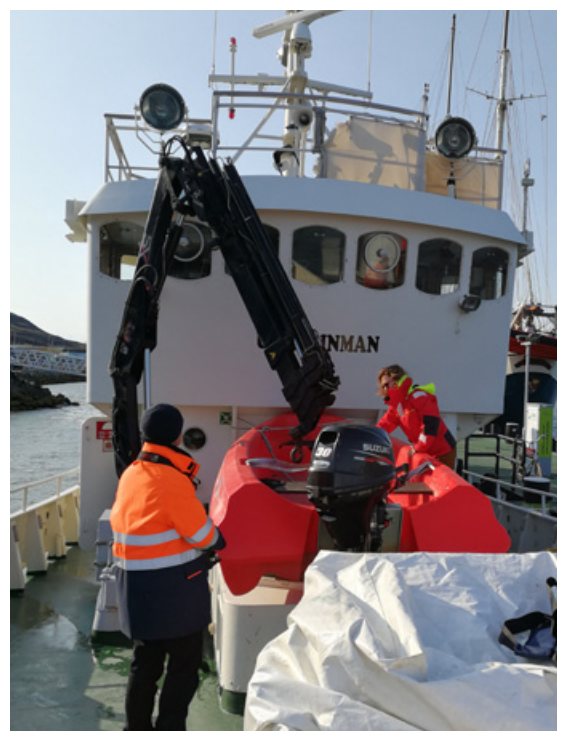



ulla arctic

your basecamp at sea



FORDECK

The foredeck offers great opportunities for placing cargo on deck, it contains of a huge 4m³ hold, accessible through a hatch of 1m x 0,75m.

On starboard side is a hydraulic crane with winch SWL 0,5t/7mtr.

On the foredeck is a 14 foot dinghy placed, equipped with a 30hp outboard engine.



AFT DECK

On the aft deck is a roof covered storage space for equipment or e.g. drying dry suits. The stern contains a comfortable seating area for passengers.

Under deck there is the food storage and two freezer.

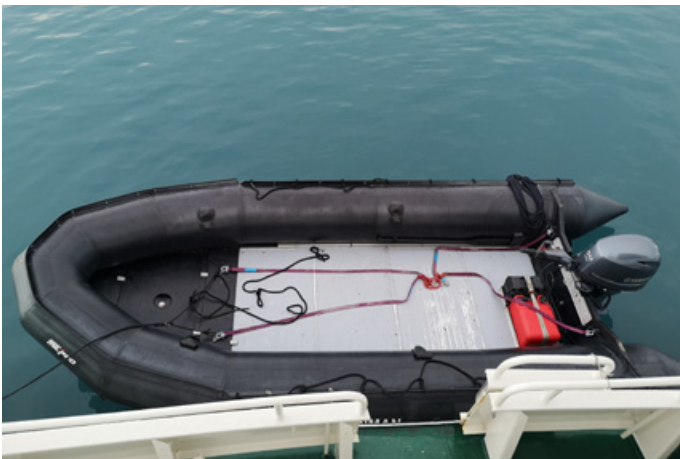



ulla arctic

your basecamp at sea



BRIDGE DECK

The bridge contains, besides navigational equipment necessary for navigator and skipper, a seating area for 6-8 people. In addition, there is plenty of space for 4-5 people (standing).

From the bridge you have access to the bridge deck and sky deck.



BRIDGE DECK AND SKY DECK

The bridge deck is equipped with different rescue gear, a 19ft rubber dinghy equipped with a 50hp outboard engine and a hydraulic crane with winch SWL 0,7t/4m.

The sky deck (above the bridge) is a very suitable viewing platform of approximately 10m² and often used as drone landing area.





ulla arctic

your basecamp at sea



MAIN DECK

The galley is located on the main deck. It is equipped with all necessary facilities like fridge, freezer, oven with 4 hot plates, coffee machine and dishwasher. Next to the galley you will find the dining area where 6-7 people can be dining at a time. Entering from the aft deck you come into the dry-room equipped with a washing machine, a dryer, a work bench for processing samples and a sink. An extra toilet is located next to the dry room.



BELOW DECK

In the front compartment there are a total of three cabins with accommodation for 7 passengers/crew (2+2+3 banks). In the front, there is also a lounge for 6-10 people for dining and/or workspace (briefing) with 90inch TV and whiteboard. In the aft compartment there are two cabins with two bunkbeds and one cabin with 4 bunkbeds for passengers/crew (2+2+4 banks).

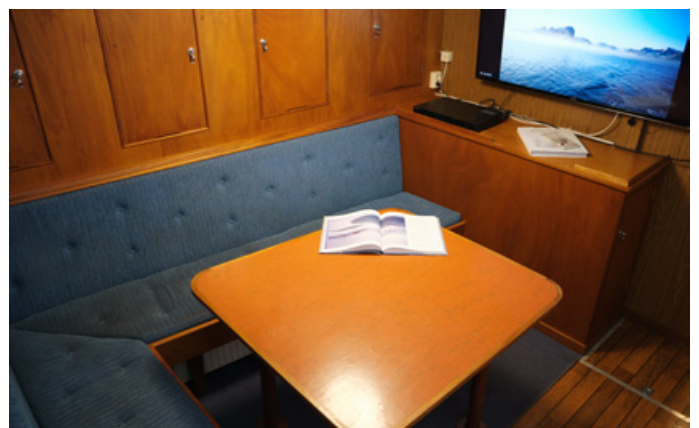



ulla arctic

your basecamp at sea

MV Ulla Rinman Callsign LKTQ

Bridge Deck

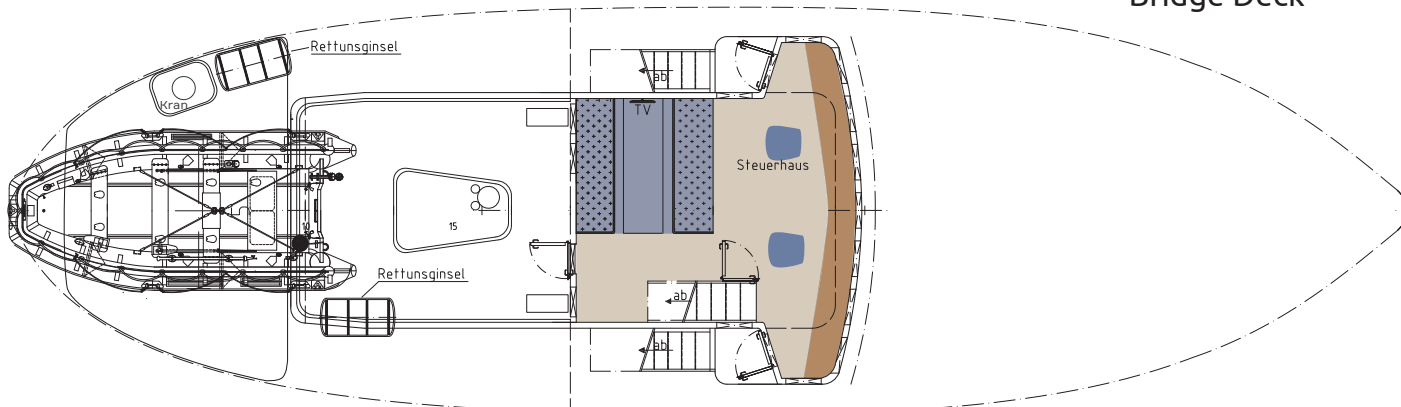

Main Deck

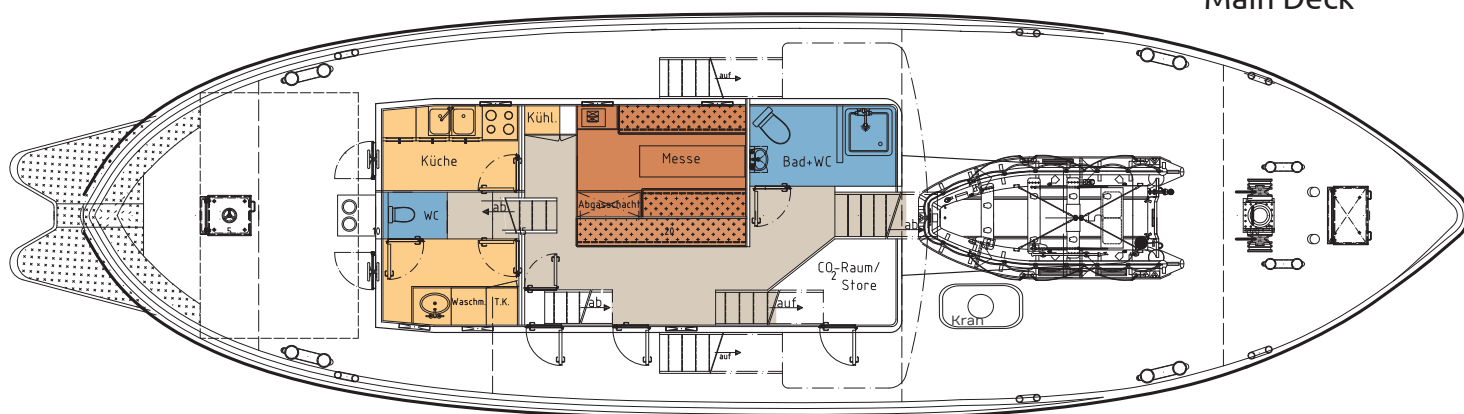

Below Deck

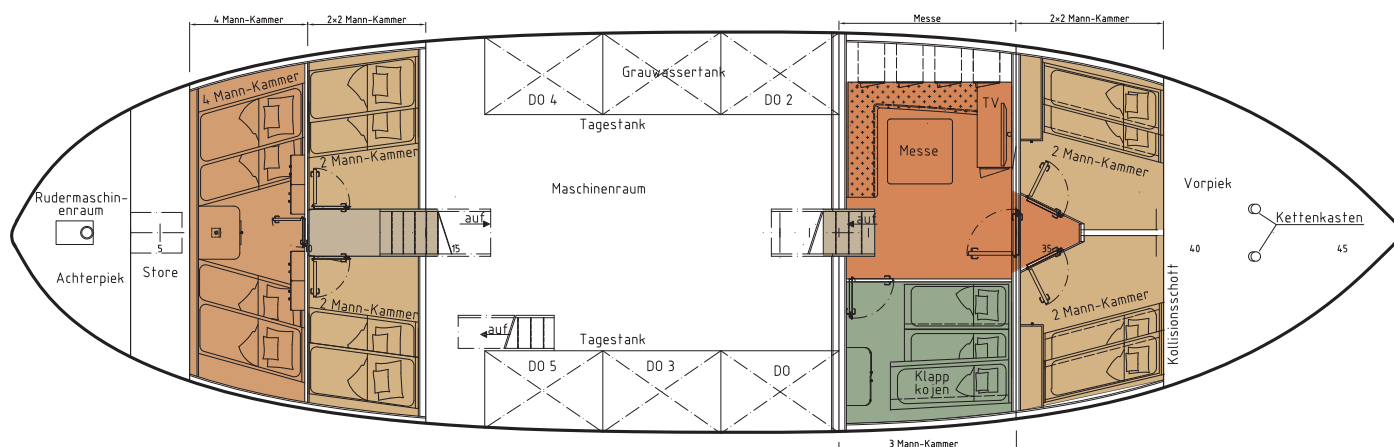

Follow us on social media



[norlengs](#)

[MV Ulla Rinman](#)

Ulla Arctic AS
Jan-F. Walther CEO

Postboks 6
9171 Longyearbyen
Svalbard

mob +49 173 5320015
tel +49 4288 95098

contact@norlengs.com
www.norlengs.com



ulla arctic

your basecamp at sea

NOR - Norsk Ordinært Skipsregister

- PANTATTEST -

Aktuelle data - *se sluttnotat

Utskriftsdato 27.03.2019 kl. 14:33

Kjenningsignal: LKTQ

Navn: ULLA RINMAN

J.nr. Dato KI

09402 09.12.2013 1300 MELDING

Fartøynavn	ULLA RINMAN
Hjemsted	LONGYEARBYEN
Byggeverft	
Byggenummer	155
Verft	AB DJUPVIKS BÅTVARV
Byggested	FALKENBERG
Nasjon	SVERIGE
Byggeår	1970
Innført fra	SVERIGE

02604 31.03.2014 0900 MÅLEBREV

Dokumentdato	26.03.2014
Fartøytype	FARTØY MED BEGRENSET PASSASJERBEFORDRING
Byggematerial	STÅL
Framdrift	MOTOR
Bredde	6,900 METER
Dybde	3,810 METER
Største lengde	23,820 METER
Bruttotonnasje	93,000
Nettotonnasje	37,000
Nasjonalitetsbevis	09.12.2013

09402 09.12.2013 1300 HJEMMELSDOKUMENT

Eier	ULLA ARCTIC AS
Org. nr	912171701
Adresse	VEI 238 24 9170 LONGYEARBYEN
Postadresse	POSTBOKS 6 9171 LONGYEARBYEN
Nasjon	NORGE
Anmerkning	HJEMMEL ERVERVET IHHT SJØLOVENS § 35

Aktuelle data = Historiske data vises ikke her.

*Datautskriften er ajour med dokumentjournalen per: 31.03.2014

RETT KOPI/UTSKRIFT BEKREFTES
SJØFARTSDIREKTORATET
SKIPSREGISTRENE

27 / 03 / 2019



Side 1 av 1



ulla arctic

your basecamp at sea



CERTIFICATE			
Of			
OWNERSHIP and ENCUMBRANCES			
<i>Hjemmel- og heftelsesattest</i>			
NAME OF VESSEL: Skip navn:	ULLA RINMAN		
CALL SIGN: Kjenningsignal:	LKTQ	IMO no.: IMO nr.:	
GROSS TONNAGE: Brutto tonnasje:	93.000	NET TONNAGE: Netto tonnasje:	37.000
HOME PORT: Hjemsted:	LONGYEARBYEN	FIRST REG. IN NOR: Reg. 1.gang i NOR:	09/12/2013 13:00 hrs
REGISTERED OWNER: Registrert eier:	09 December 2013 at 13:00 hrs ULLA ARCTIC AS VEI 238 24 9170 LONGYEARBYEN NORWAY		
The following encumbrances are registered upon the vessel: Det er registrert følgende heftelser på skipet: - - - - N O N E - - - - - Issued by The NORWEGIAN ORDINARY SHIP REGISTER Utstedt av NORSK ORDINÆRT SKIPSREGISTER Bergen, 27 MARCH 2019 at 08:00 hrs Fee 629 NOK * Fixed units or floating units are registered as 'vessels' * Fast eller flytende innretninger registreres som 'skip'			